

RESOLUTION NO. R-02-2018

**A RESOLUTION OF THE REDEVELOPMENT AGENCY OF
EAGLE MOUNTAIN CITY, UTAH
INITIATING THE PROCESS OF ADOPTING
ONE OR MORE COMMUNITY REINVESTMENT PROJECT AREA PLANS
BY DESIGNATING A SURVEY AREA KNOWN AS
THE SWEETWATER INDUSTRIAL PARK SURVEY AREA #1.**

WHEREAS the Eagle Mountain City, Utah (the "City"), created the Eagle Mountain City Redevelopment Agency (the "Agency") pursuant to the provisions of, and the Agency continues to operate under, Title 17C of the Utah Code, known as the Community Reinvestment Agencies Act (the "Act"), for the purposes of conducting community reinvestment activities within the City, as contemplated by the Act; and

WHEREAS the Agency desires to initiate the process of adopting one or more community reinvestment project area plans by adopting this resolution establishing the boundaries of the Sweetwater Industrial Park Survey Area #1 (the "Sweetwater Survey Area"); and

WHEREAS the boundaries of the Sweetwater Survey Area are depicted on the map attached to this resolution as Exhibit A and the Sweetwater Survey Area is located entirely within the Agency's boundaries;

NOW THEREFORE, BE IT RESOLVED by the Governing Board of the Eagle Mountain Redevelopment Agency as follows:

1. The Sweetwater Survey Area requires study to determine whether project area development is feasible within one or more proposed community reinvestment project areas within the Sweetwater Survey Area. Agency staff, consultants and legal counsel are authorized and instructed to conduct such study.
2. Agency staff, consultants and legal counsel are authorized to prepare a proposed community reinvestment project area plan, and accompanying project area budget, for each proposed community reinvestment project area designated by them in the Sweetwater Survey Area, and to conduct any examination, investigation, or negotiation regarding each proposed community reinvestment project area that they consider appropriate, and to take all other actions under the Act which may be appropriate for the successful establishment of any proposed project area(s), including, without limitation, discussions with taxing entities, the preparation for all necessary hearings, the preparation, publication, and/or mailing of statutorily required notices, and the preparation, presentation, and negotiation of any and all interlocal cooperation agreements and related documents.
3. This resolution takes effect upon its adoption.

ADOPTED by the Redevelopment Agency of Eagle Mountain City, Utah this 3rd day of April, 2018.

Tom Westmoreland, Board Chair

ATTEST:

Aaron Sanborn, Executive Director



CERTIFICATION

The above resolution was adopted by the Redevelopment Agency of Eagle Mountain City on the 3rd day of April, 2018.

Those voting aye:

- Donna Burnham
- Melissa Clark
- Colby Curtis
- Stephanie Gricius
- Benjamin Reaves

Those voting nay:

- Donna Burnham
- Melissa Clark
- Colby Curtis
- Stephanie Gricius
- Benjamin Reaves



Aaron Sanborn, Executive Director

EXHIBIT A

EXHIBIT A
MAP OF SWEETWATER SURVEY AREA BOUNDARIES

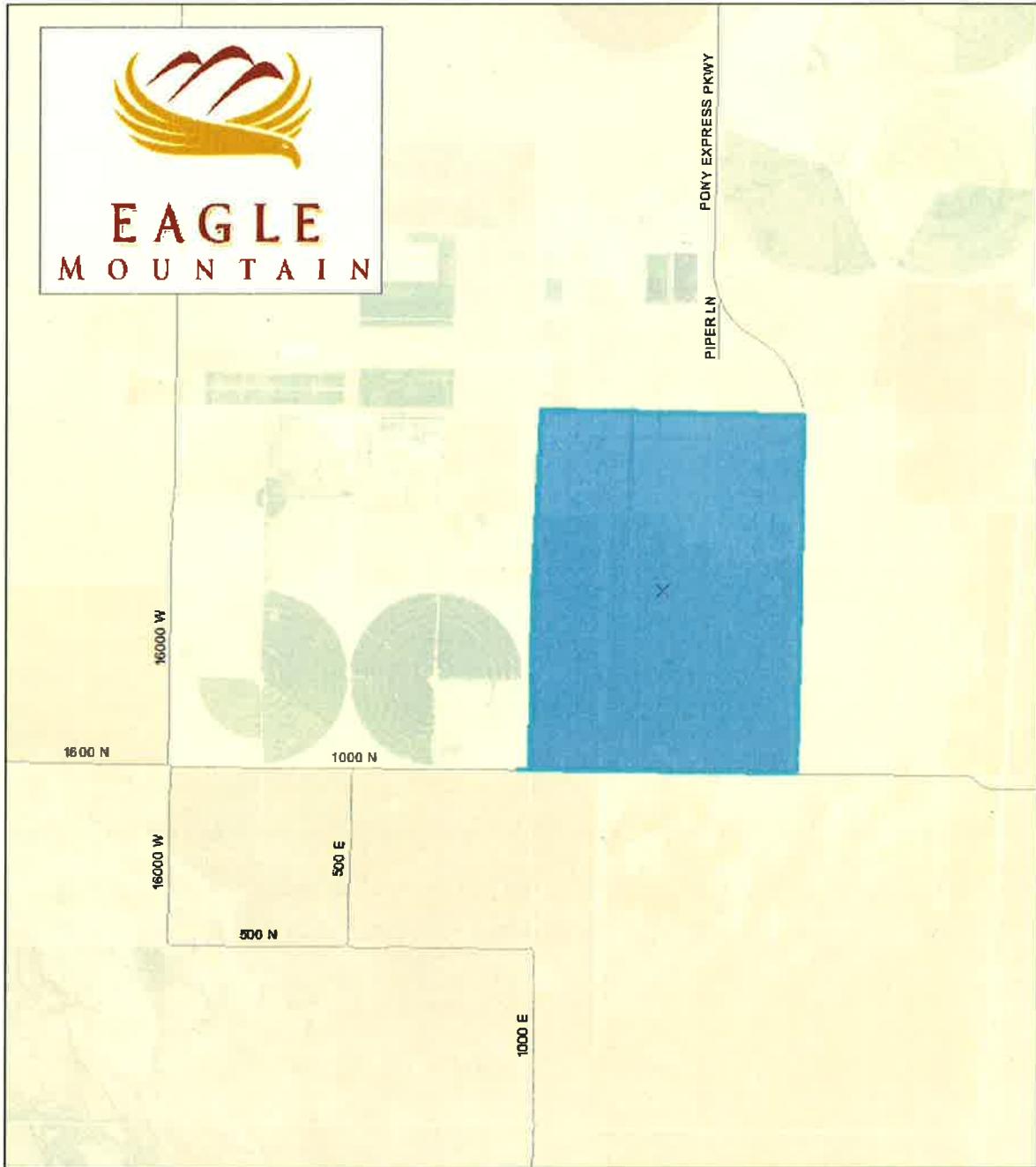

SWEET WATER INDUSTRIAL PARK CRA #1

 Sweet Water Industrial Park Boundary

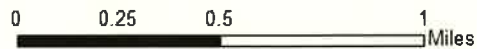

LEWIS YOUNG
ROBERTSON & BURNINGHAM, INC.

